

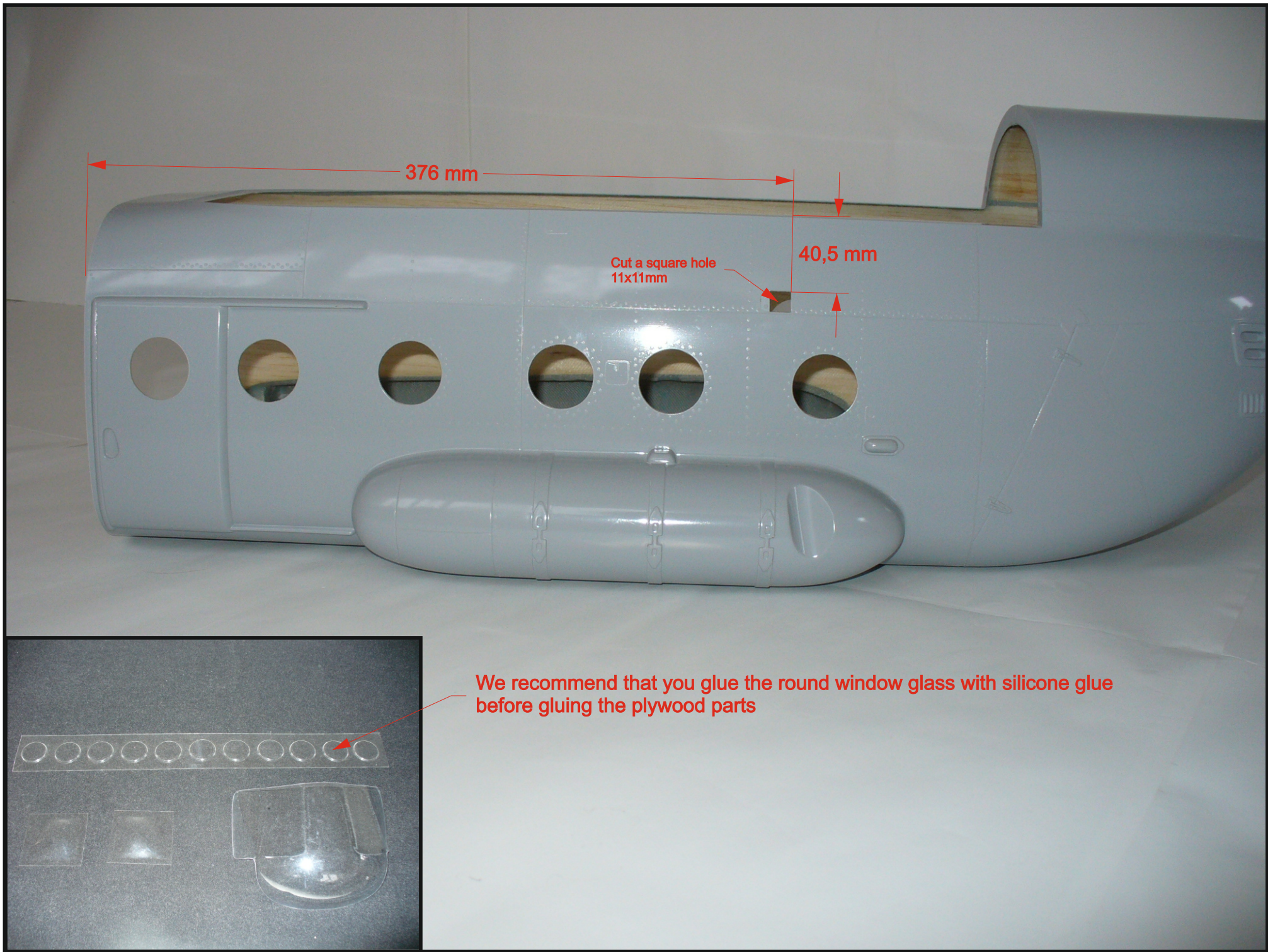

**Assembly manual of MI-8 MT scale kit**



376 mm

40,5 mm

Cut a square hole  
11x11mm

We recommend that you glue the round window glass with silicone glue before gluing the plywood parts

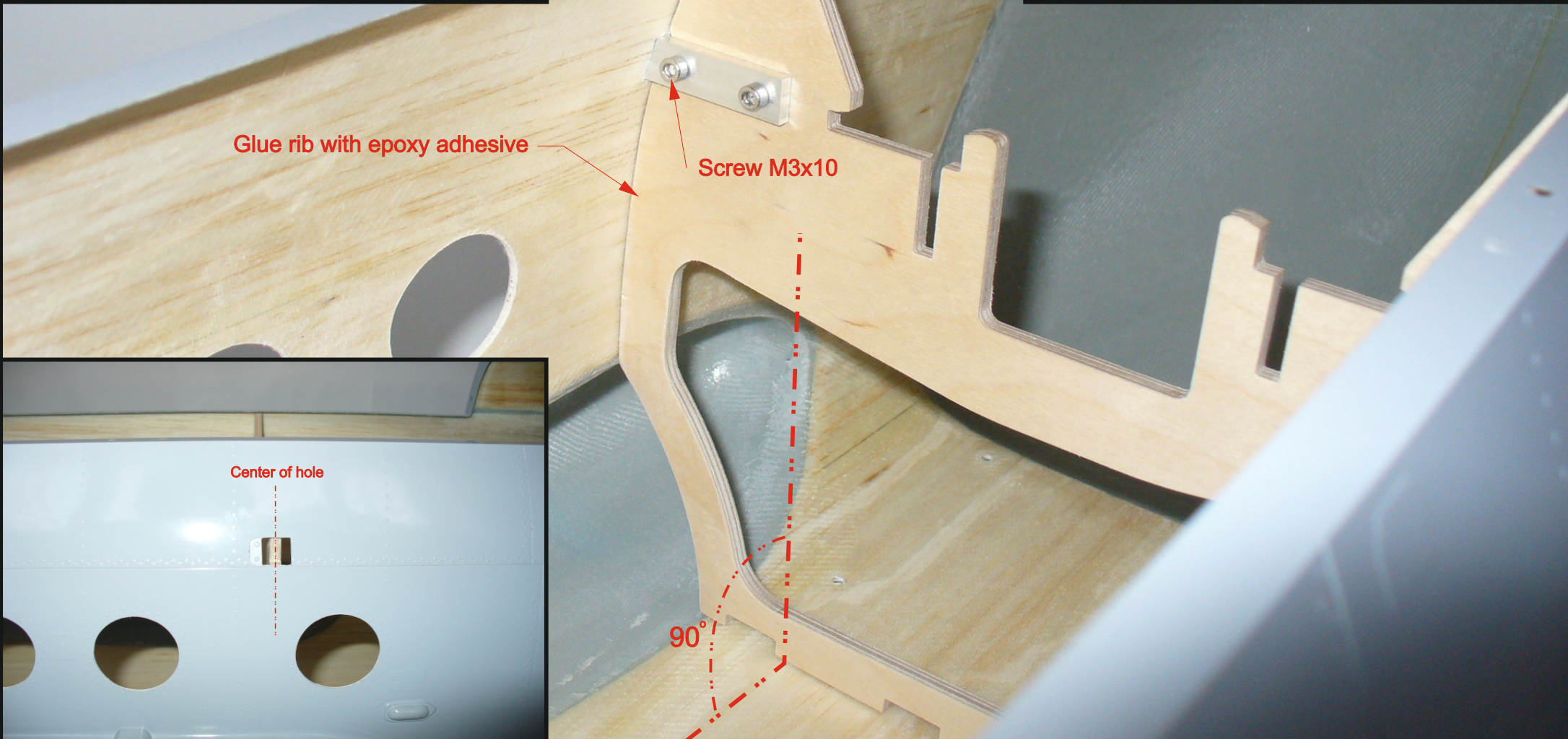

Glue rib with epoxy adhesive

Screw M3x10

90°

Center of hole



Assemble all the parts according to the pictures and glue with epoxy

155 mm





Assemble all the parts according to the pictures and glue with epoxy

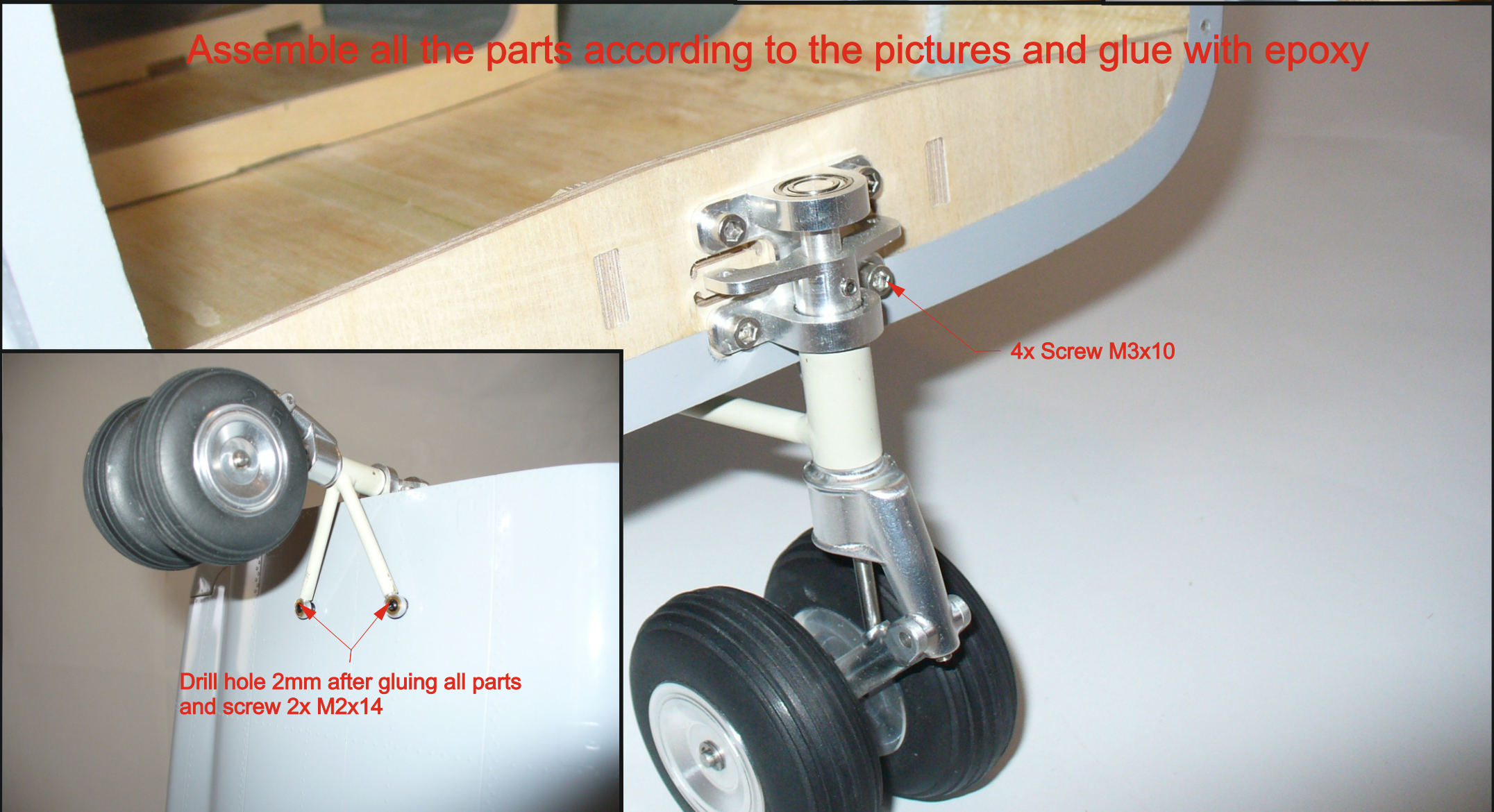

4x Screw M3x10

Drill hole 2mm after gluing all parts and screw 2x M2x14



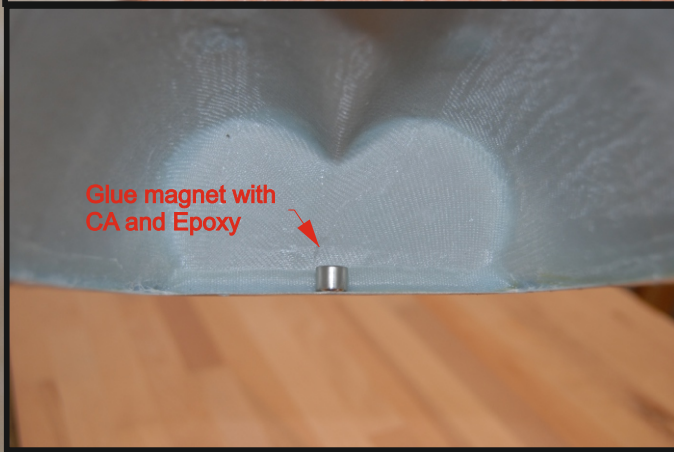
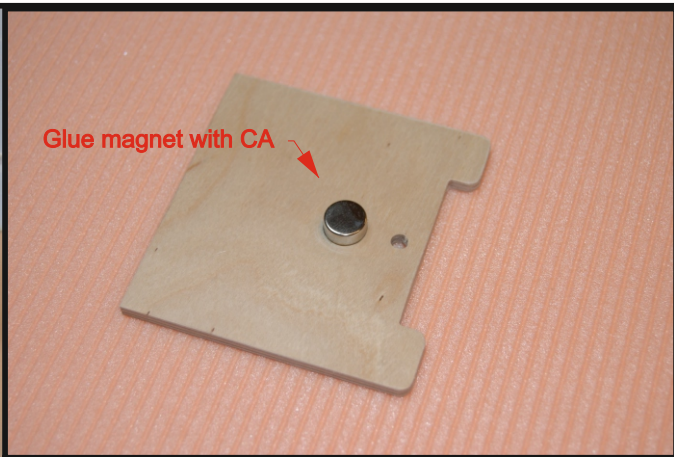
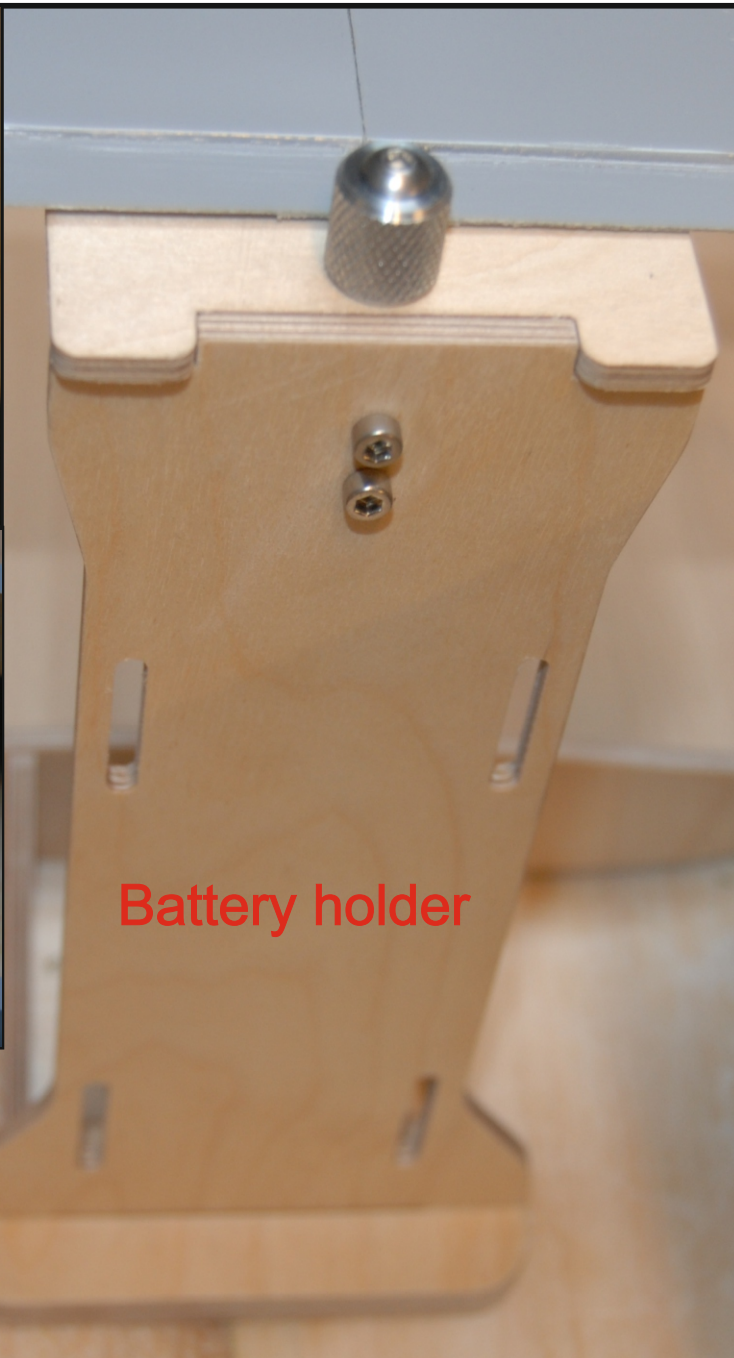
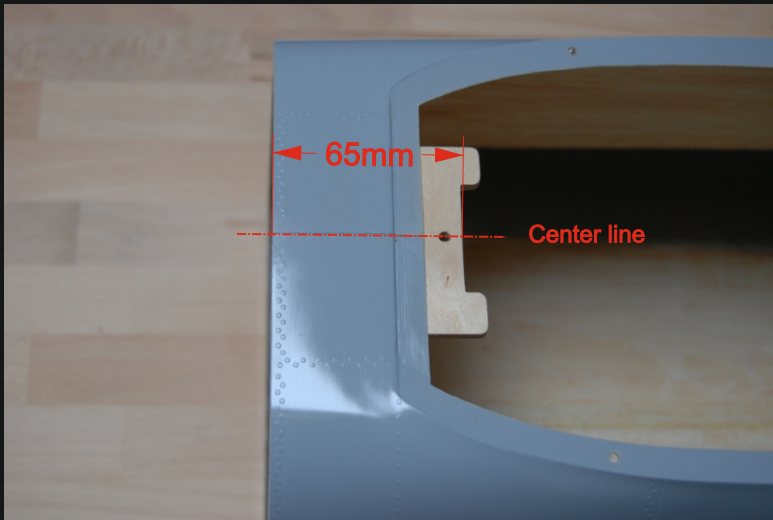

Assemble all the parts according to the pictures and glue with epoxy

Cut a square hole 8x8mm

Glue with epoxy

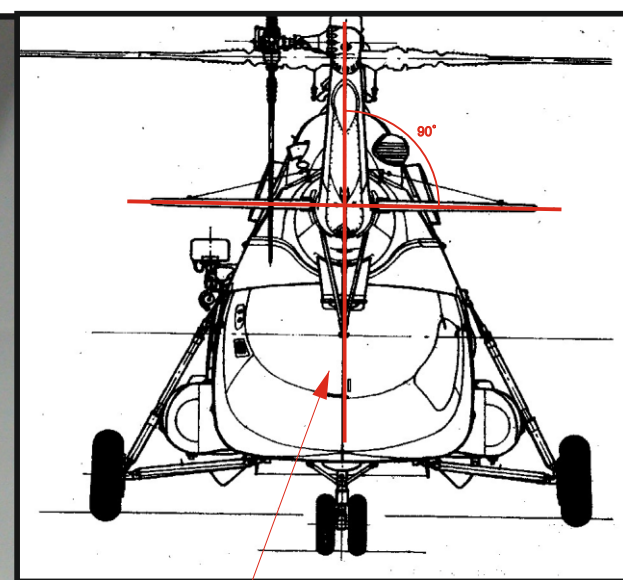

**!!! BEWARE OF SYMMETRY !!!**

Check that both horizontal stabilizers are horizontal and at 90 degrees to the center line through the vertical fin

Drill hole 6 x 1.5mm and screw

Roughen the surface  
and glue with epoxy

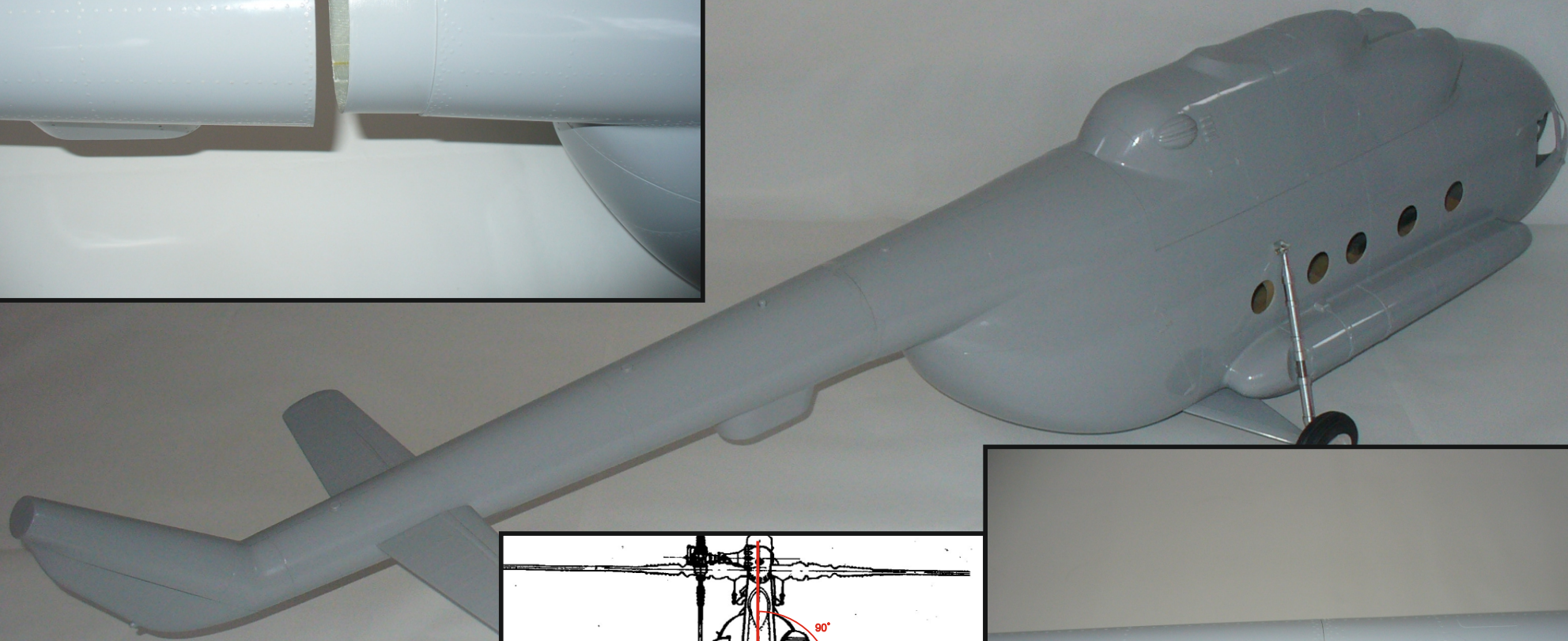

!!! BEWARE OF SYMMETRY !!!

Check that the fin is vertical

