

MI-8 cockpit assembly manual

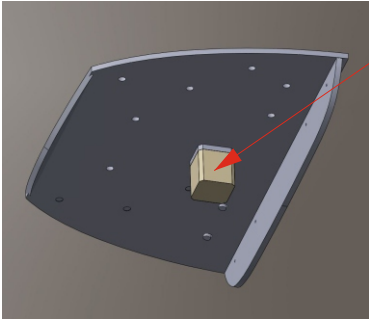

- 1 Screw cockpit holder by wood screw 2.5x10
- 2 Put floor of the cockpit inside the fuselage

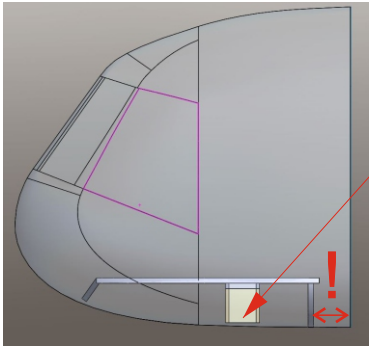
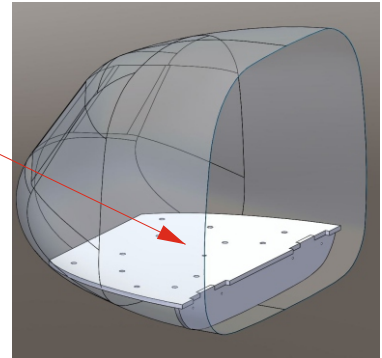

- 3 Glue cockpit holder in correct position (see picture) by epoxy glue

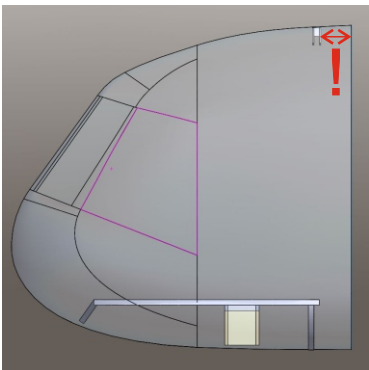
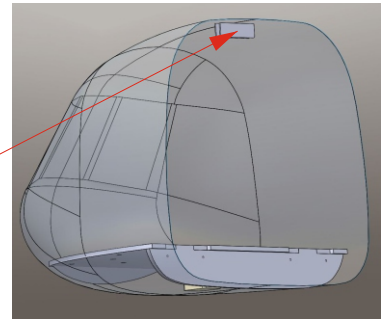

- 4 Glue upper cockpit holder in correct position (see pictures) by CA glue

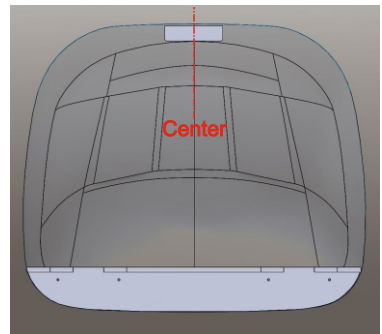

- 5 Now unscrew the wood screw and remove the cockpit floor from fuselage

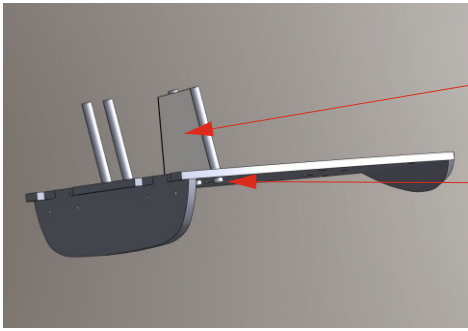

6 Glue 4 pcs of CFK tubes to the floor by CA glue
For correct length and angle use the template

TIP: Glue only from bottom side by thin CA

7 Now you can assembly all cockpit parts by picture

TIP: Glue only from bottom side by thin CA

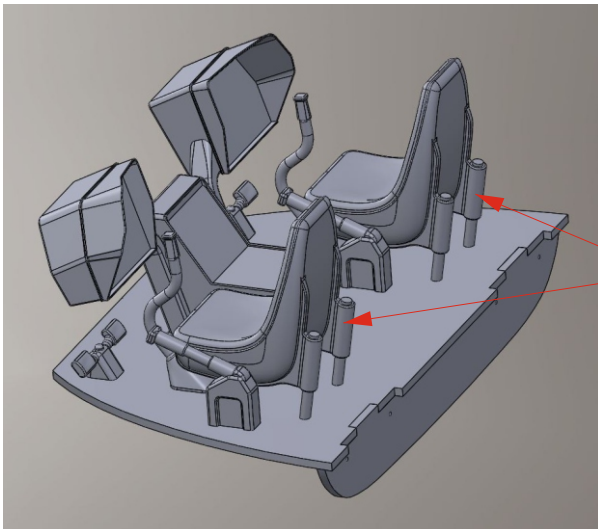
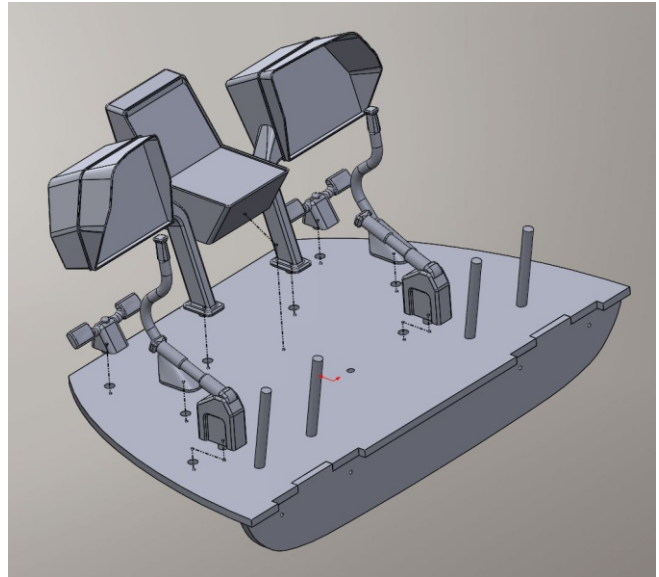

7 Now assembly the seats on the CFK tubes and glue by CA glue

Final assembly

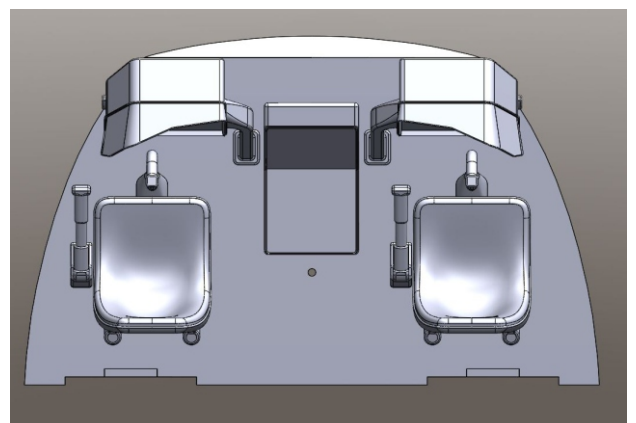
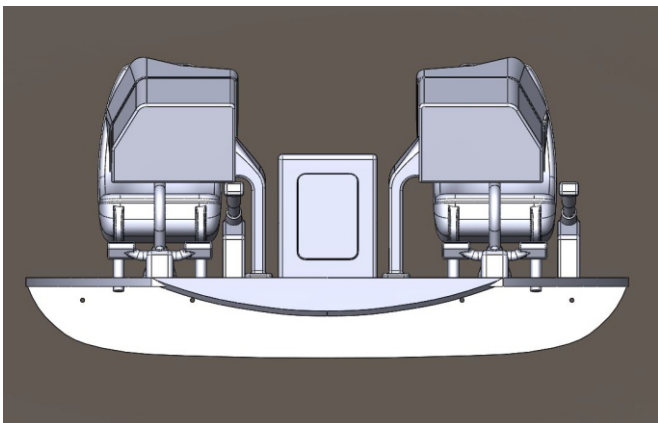

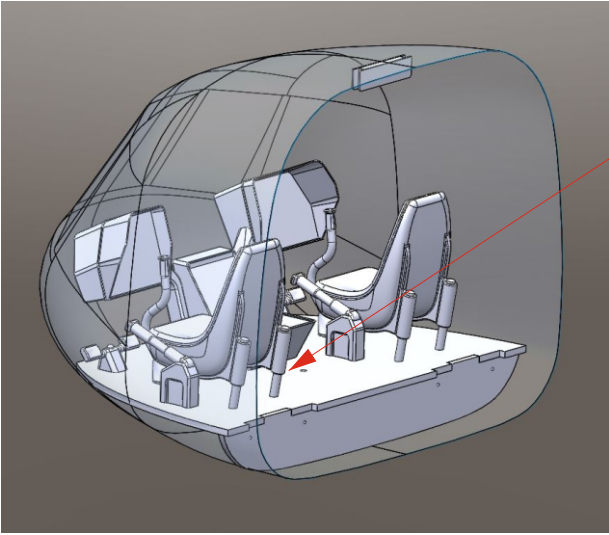

8 Now you can return the cockpit to the fuselage and screw by wood screw 2.5x10

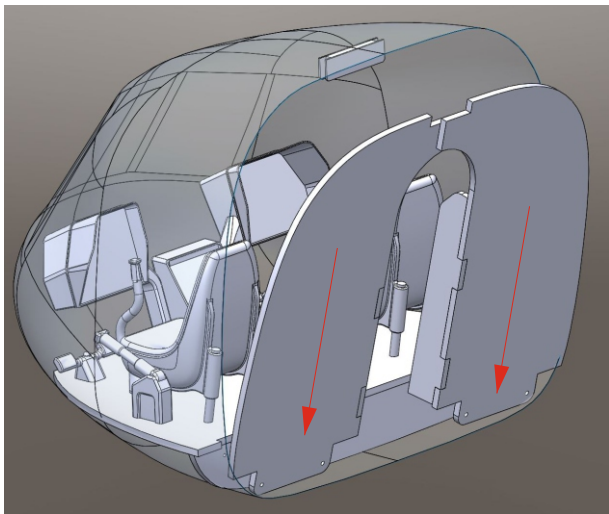

9 Insert rear parts of cockpit to the fuselage (see picture)

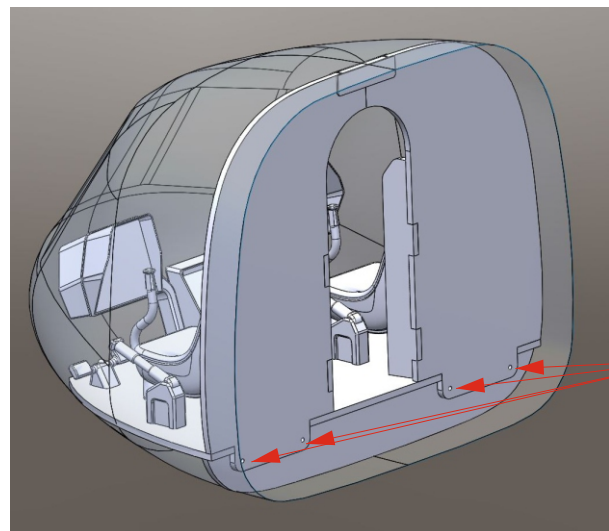
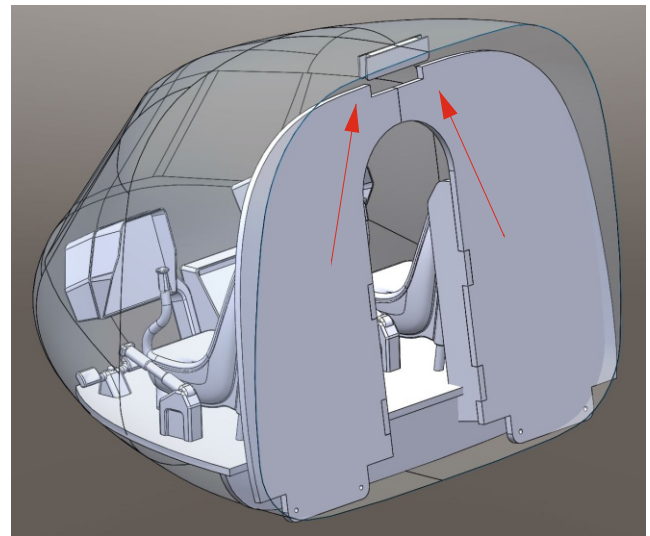

10 Screw rear parts of cockpit by 4 pcs wood screw 2.5x10

11 Time for beer